

SWEEPER-AL

Sweeper AL – speed gate system based on Sweeper and Sweeper-HG models combination with swing type flaps and reliable mechanism with brushless motor. The construction of the system allows to arrange two checkpoints for access verification.

Possibility of various biometric devices integration along with various glass height options at every checkpoint (overall height could be 1000-1800 mm) provide maximum security control during passage of people through the gate to protected area.

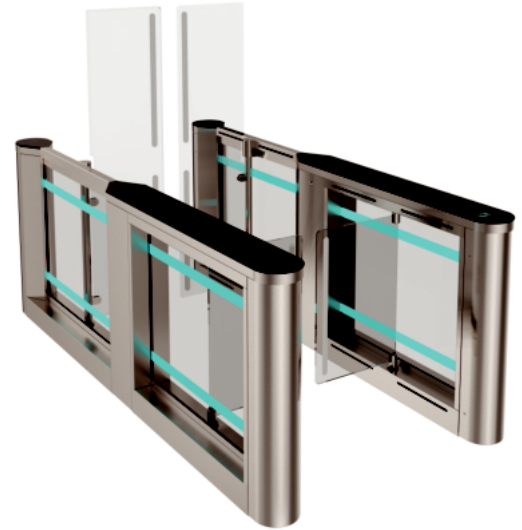

ELEGANT ACCESS SOLUTIONS WITH TWO-STAGE IDENTIFICATION SYSTEM

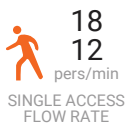
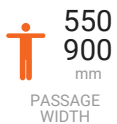

Key features:

- BMDrive® - Sweeper AL is equipped with BM drive (reliable mechanism with powerful brushless motor), which provides long-term maintenance-free and trouble-free operation
- Innovative motor controller with OLED display and buttons for easy setup and configuration without special programmers
- Sweeper AL smart self-diagnostic system automatically detects critical malfunctions, and records error log and warnings
- Digital control of force and leaf speed, combined with safety sensors, prevents accidents and ensures the safety of individuals, even in cases of unauthorized passage
- Safety sensors system allows detecting the passage of person with luggage, or arranging a free exit without necessity of identification

- Ability to arrange two checkpoints for access verification
- Elegant cabinets equipped with integrated LED lighting to display access status and card reader area
- Same dimensions of cabinet for normal (550 mm) and wide lane (900 mm)
- The ability to customize cabinet and top lid design as per project requirements
- Low power consumption
- Sweeper AL supplied with wired push button by default
- Availability of integration with any access control system



Technical Specifications:

Model	Sweeper-AL	
Cabinet width, mm	208	
Cabinet length, mm	2663	
Cabinet height, mm	1010	
Leaves height, mm	1520/1800	
Passage width, mm	550	900
Opening/closing time, sec	1,2	1,8
Mechanism	Servo-driven (Motorized)	
Emergency mode (fire-alarm)	Free entry/exit (leaves are opened automatically)	
Power fail	Fail safe (gates could be opened manually — standard)	

Electrical Specifications:

Maximum power consumption, W	310	
Voltage	From the AC (100-240)V, 50/60Hz; from a DC source 12 V	
Indication	DotLights®, RFIDLights®, EdgeLights®	

Finishing

Standard housing	Brushed SS AISI 304	
Available housing	Brushed SS AISI 316; Polished SS AISI 304; Polished SS AISI 316; Powder coated RAL	

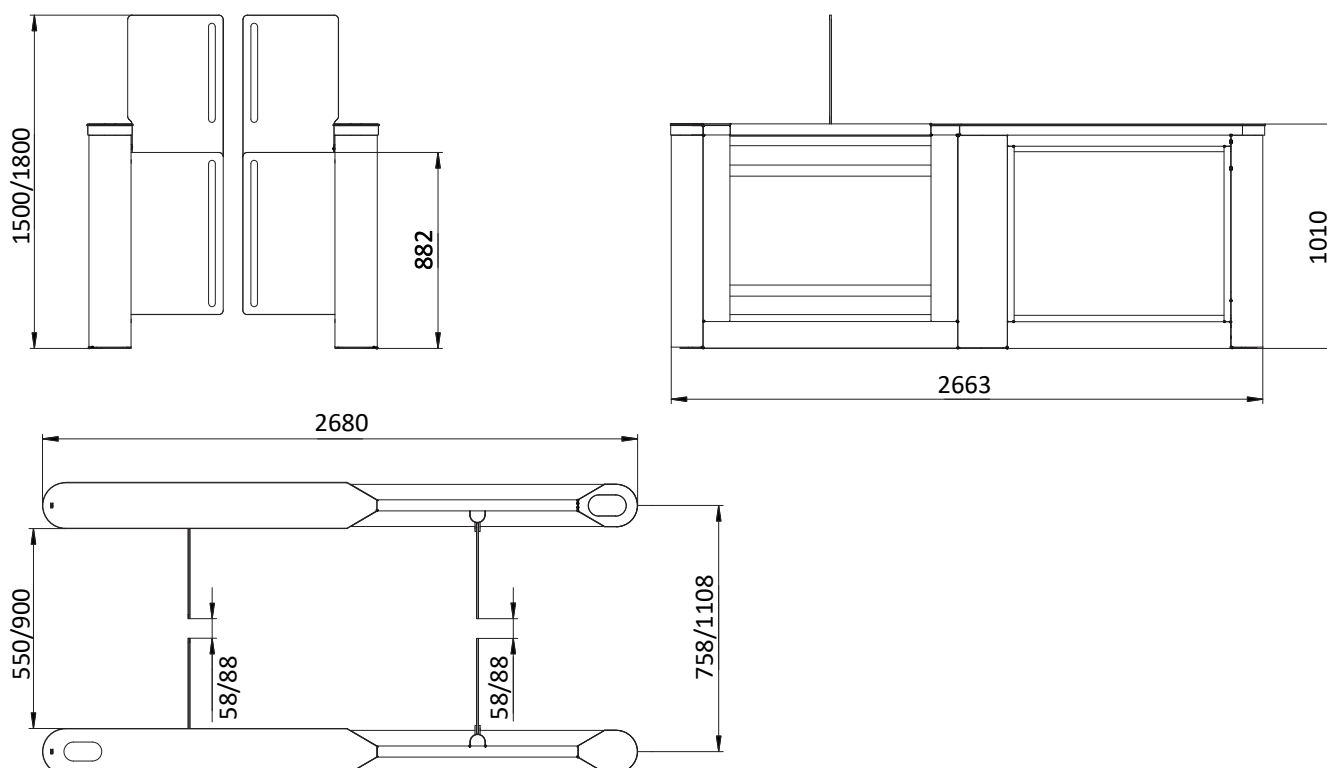

Specifications are subject to change without prior notice.



www.tiso.global
+380 (44) 291-21-11
e-mail: sales@tiso.global

